

144

Courses and distances
down the Creek C-133-38

- S. 24 1/2 E. 8.
- S. 78 E. 7.
- S. 29 E. 19
- S. 39 W. 9
- S. 21 W. 18
- S. 86 W. 7.
- S. 27 1/2 W. 13
- S. 1 E. 7
- S. 13 1/2 W. 20.
- S. 46 1/4 W. 17 1/10 Stone.

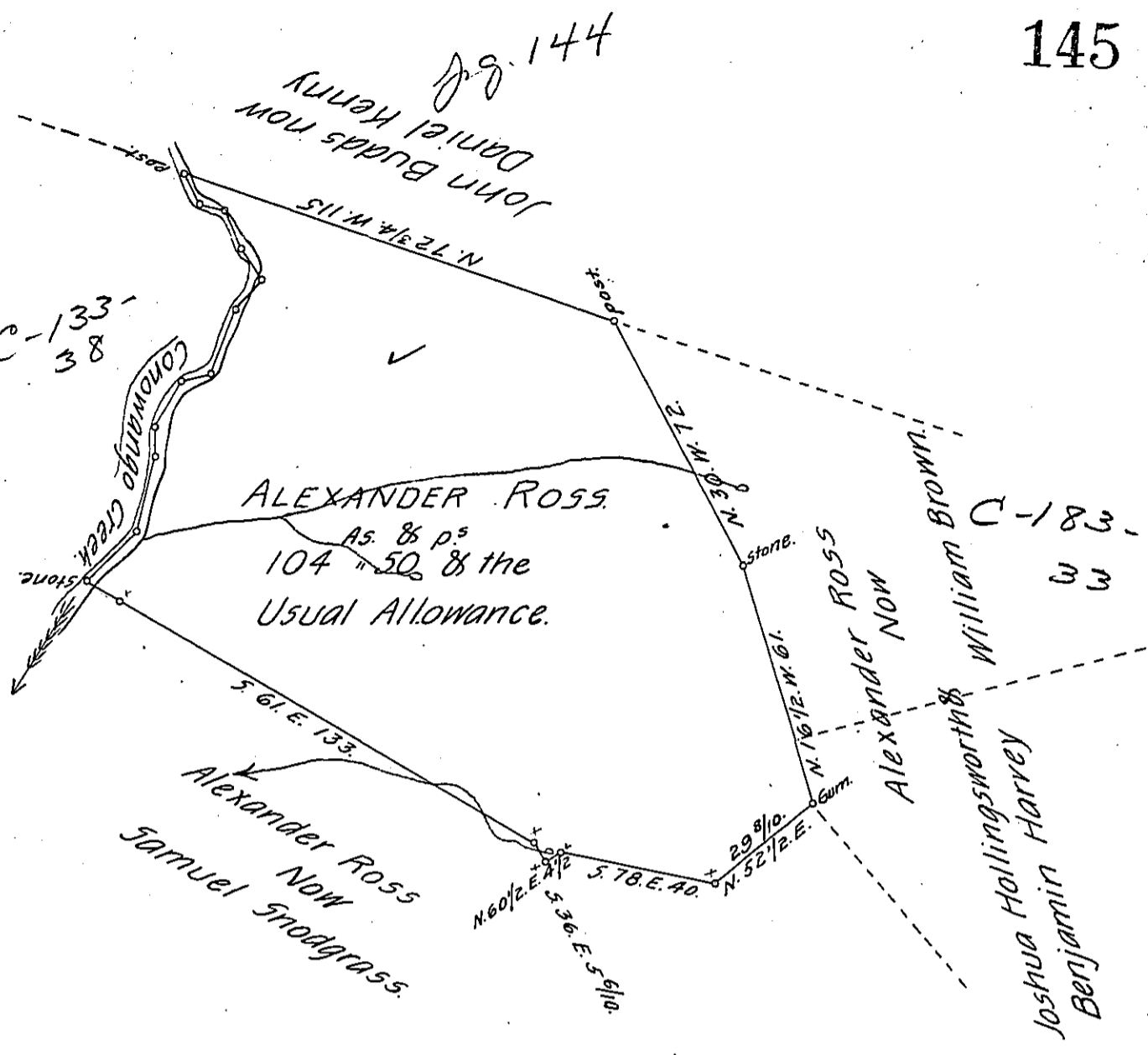

A Draught of a Tract of land Situate in Little Britian Township, in the County of Lancaster. Containing One hundred and four Acres and fifty perches and the usual Allowance of Six $\frac{1}{2}$ Cent for Roads &c part of five hundred Acres Surveyed in pursuance of a Warrant dated the fifth day of November A.D. 1714. Granted unto Alexander Ross. Surveyed the 15th of June A.D. 1809, for Daniel Kenny.

per Jacob Hibshman, D.S.

To Andrew Porter, Esq: }
Surveyor General. }

IN TESTIMONY that the above is a copy of the original remaining on file in the Department of Internal Affairs of Pennsylvania, made conformably to an Act of Assembly approved the 16th day of February, 1833, I have hereunto set my Hand and caused the Seal of said Department to be affixed at Harrisburg, this twenty-fifth day of June 1906.

Isaac R. Brown
Secretary of Internal Affairs.